

## Tornado Guard



OGi is proud to introduce **TornadoGuard**, a steel louver system designed and tested to meet the requirements of FEMA 361 for tornado shelters.

**TornadoGuard** is manufactured using heavy duty steel plates and channels to provide a rated exterior louver that can withstand 300 mph winds and a 100 mph large missile impact.

**TornadoGuard** panel sizes are available up to 7'-0" in width and 12'-0" in height. The louver can also be fabricated into asymmetrical shapes as well as doors and hatches. A galvanized steel or stainless steel birdscreen is also available upon request.

**TornadoGuard**, manufactured from carbon steel or stainless steel material, is 100% made in the USA. It also meets LEED requirements for MR4.2 (20% Recycled Content).

Carbon steel louvers are furnished in a hot-dip galvanized finish and are available with powder coat or *Kynar* finishes. Stainless steel louvers can be passivated with a sandblast finish.

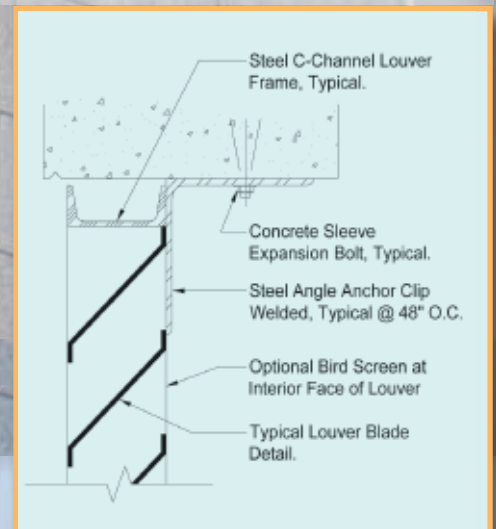

▲ **Detail**  
**TornadoGuard** LW-100



# LOUVER ALUMINUM

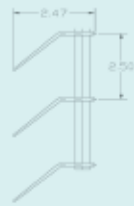

**VisiScreen**  
LG-60  
Open Area: 64%  
Visual Block: 60%

Grilles



**VisiShield**  
LG-75  
Open Area: 64%  
Visual Block: 75%

Sunshades

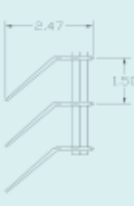

**VisiBlock**  
LG-100  
Open Area: 63%  
Visual Block: 100%

Fence / Gates

**Visi-Series** aluminum louvers are manufactured using 6105-T5 alloy aluminum louver blade extrusions and are designed and tested to meet requirements of Miami-Dade Zone 5 hurricane building code compliance for non-occupiable spaces.

**Visi-Series** aluminum louvers are available in three typical configurations to allow for different percentages of visual block and open area (see *Load Table* below).

**Visi-Series** aluminum louvers are available in a wide variety of sizes and can be engineered and fabricated specifically for your project needs. OGI also offers a J-Channel and Pressure Plate frame system which can facilitate installation into façade openings. Stainless steel or aluminum birdscreen products are also available upon request.

**Visi-Series** aluminum louvers are extremely versatile and are used frequently for fences, gates, privacy screens, sunshades and ventilation grilles.

**Visi-Series** aluminum louvers, manufactured from extruded aluminum blades and square cross rods, are 100% made in the USA. They can also meet LEED requirements for MR4.2 (20% Recycled Content) and are available in a variety of anodized, powder coat or Kynar finishes.

Contact your OGI representative for more information on either of these two fine products.

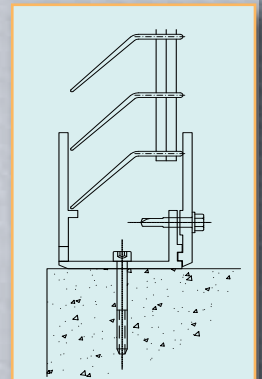

▲ **Detail**  
J-Channel w/ Pressure Plate Frame System

## Load Table

PRODUCT	VISUAL BLOCK	WEIGHT (LBS./SQ.FT.)	SEC. PROP / FT. WIDTH SX, IN <sup>3</sup> LX, IN <sup>4</sup>	CLEAR SPAN								
				5' - 0"	6' - 0"	7' - 0"	8' - 0"	9' - 0"	10' - 0"	11' - 0"	12' - 0"	
<b>VisiBlock</b>	100%	3.57	1.017	U	.325	.226	.166	.127	.100	.081	.067	.057
			1.254	D	.365	.526	.715	.934	1.182	1.460	1.766	2.102
<b>VisiShield</b>	75%	2.81	.773	U	.247	.172	.180	.097	.076	.062	.051	.043
			.953	D	.365	.526	1.020	.934	1.183	1.460	1.767	2.102
<b>VisiScreen</b>	60%	2.35	.626	U	.200	.139	.102	.078	.062	.050	.041	.035
			.773	D	.364	.525	.714	.933	1.181	1.458	1.764	2.099

U = Safe uniform load in lbs./sq.ft D = Deflection inches



**OGI Architectural Metal Solutions**  
an Ohio Gratings company

**NOTE:** Load and deflections given in this table are theoretical and are based on a unit stress of 12,000 psi.